

© 2016 RPS Group

Notes

1. This drawing has been prepared in accordance with the scope of RPS's appointment with its client and is subject to the terms and conditions of that appointment. RPS accepts no liability for any use of this document other than by its client and only for the purposes for which it was prepared and provided.
2. If received electronically it is the recipient's responsibility to print to correct scale. Only written dimensions should be used.
3. This drawing should be read in conjunction with all other relevant drawings and specifications.

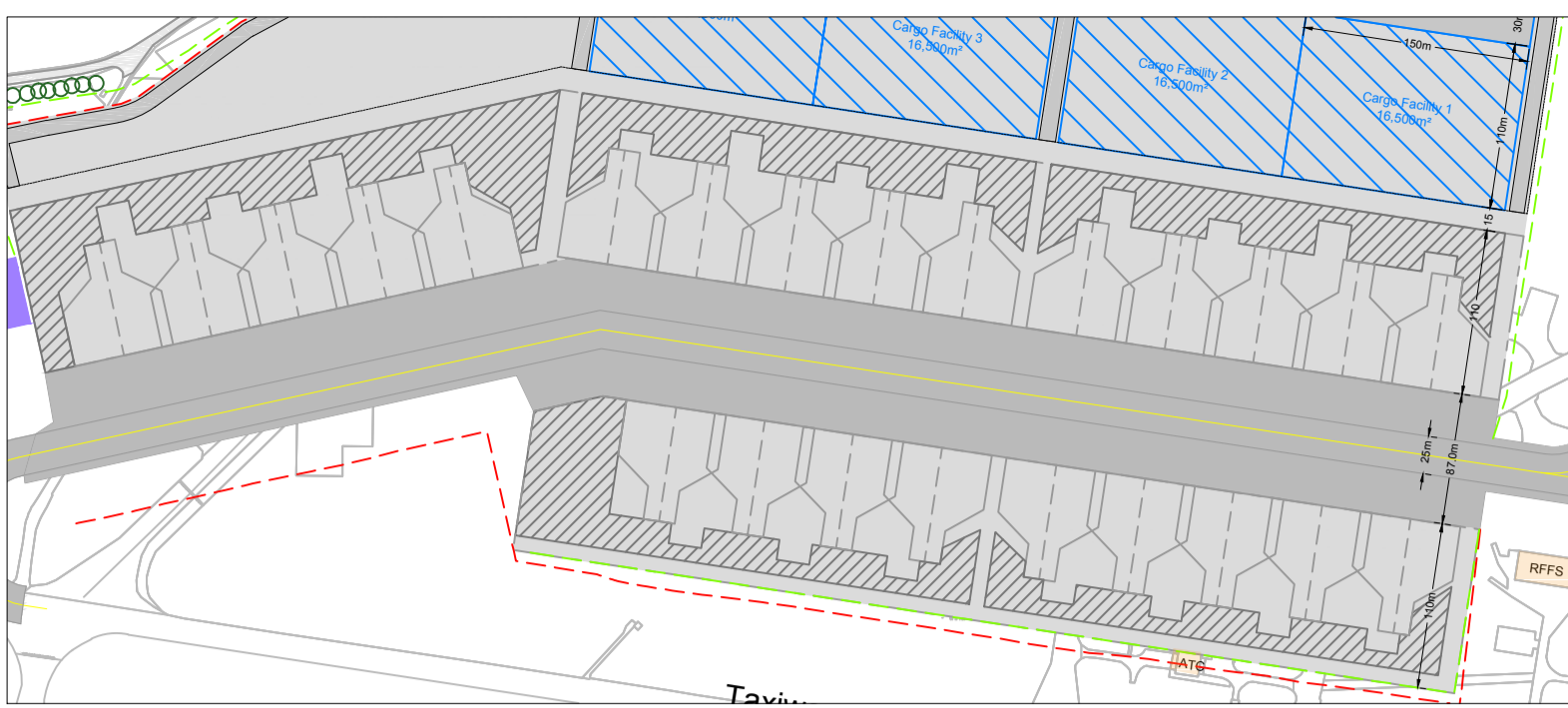

Code D Aircraft Configuration (24 positions)  
Scale 1:5000



Code E Aircraft Configuration (19 positions)  
Scale 1:5000



Code F Aircraft Configuration (6 positions)  
Scale 1:5000

**Proposed Option**

- Characteristics:
- Number of Code E Stands: 19 (6 Code F)
  - Cargo Building: 4 x 16,500 = 66,000 m<sup>2</sup>
  - Storage and park area: 120,000 m<sup>2</sup>
  - Taxiway + Apron Area: 280,000 m<sup>2</sup>

Note:

Code F stands may be increased if necessary. The proposed configuration maximize the handling and storage areas beside the stands.

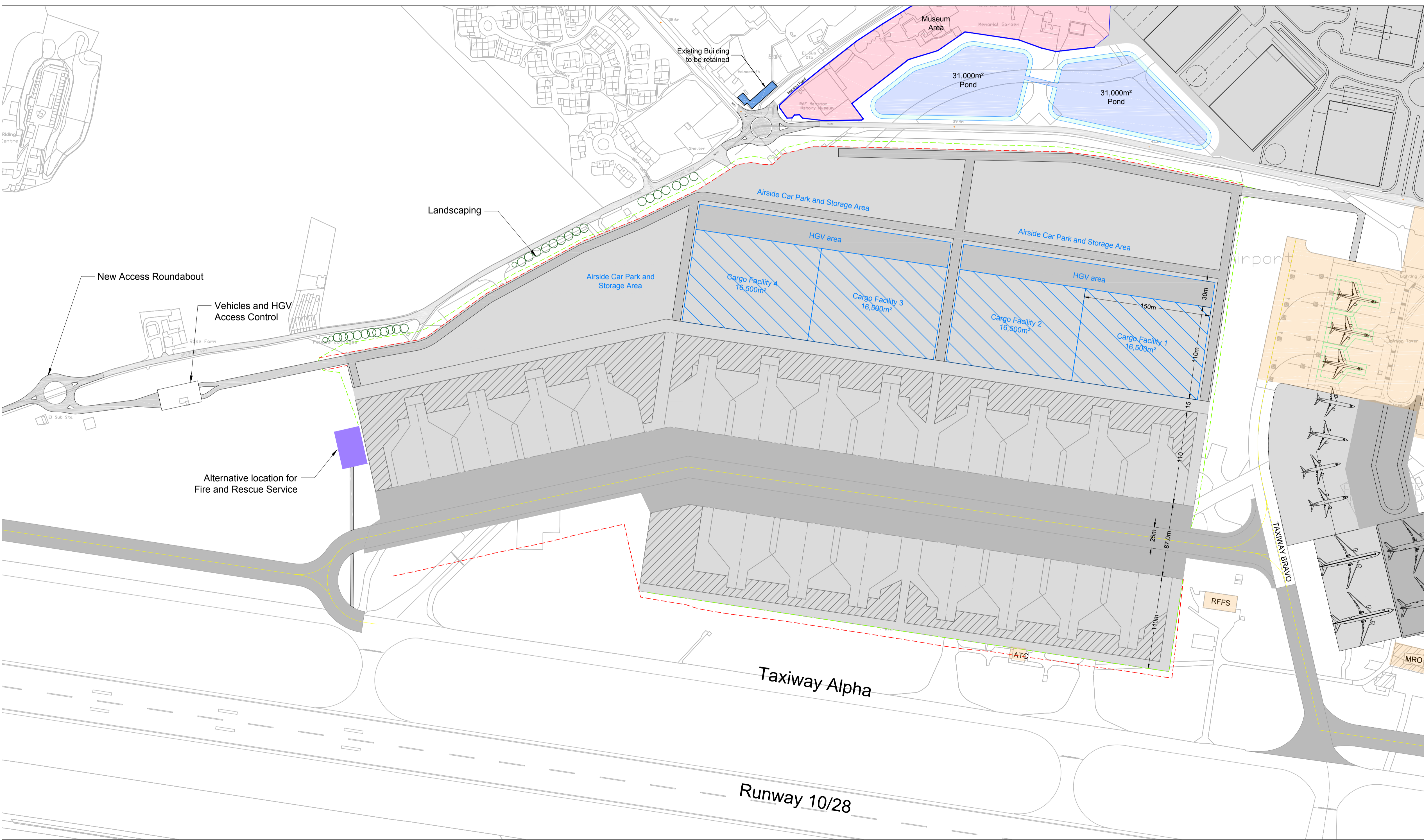

Cargo Area. Plan View  
Scale 1:2500

50m SCALE 1:2500

P01	First Issue.	JLE	GD	09.06.16
Rev	Description	By	Ckd	Date



Sherwood House, Sherwood Avenue,  
Newark, Nottinghamshire, NG24 1QQ  
T:01636 605 700 E: rpsnewark@rpsgroup.com



Project Manston Airport Masterplan

Title **Figure 2.3**  
Proposed Layout  
General Arrangement  
Cargo Area

Status	Scale	Date Created
Preliminary	Shown @A1	03/06/2016
Project Leader	Drawn By	Checked by
GD	JLE	GD

Document Number	Revision	Subsity
NK018417 - RPS-MSE-X-DR-C-0322	P01	S0
Project Number	Original	Zone
	Level	Type
	Scale	Drawing Number